

## Good Design award

### The Next Generation Tool Series

#### NEW model Ratchet Handle

Extremely thin, light and compact. 72-tooth gear equipped in the head achieves low swings with the repeating angle of 5°. Unified claw with more gear teeth ensures efficient operation. Light click sound! You will encounter never-experienced smoothness. ※ RH2CHS is 6 deg of feed corner.

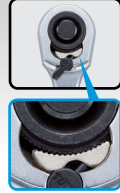

Thinner, lighter and smaller!



The whole design was unified! A wide range of tools can respond to the various needs!



#### NEW model Spinner Handle, Flexible Head Ratchet Handle

TONE's new spinner/ratchet handle allow you to access and fasten bolts in a narrow place. New mechanism that can adjust the angle by 15 degree makes your work smoothly.



#### NEW model Grip Design

TONE's logo is not only for identity but also for non-slip function. The shot-blasted grip part is I-shaped designed to make the product lighter.



#### How to see

Model	Sq.dr	Feature	Length
RH Ratchet handle	2 6.35	F Flex head	S Short
NS Spinner Handle	3 9.5	C Compact	L Long
	4 12.7	H Socket hold type	X Super long

## RATCHET HANDLE(SOCKET HOLD TYPE)

Models	Square Drive (mm)	Dimensions (mm)				Qty./ Carton (Generally)	Weight (g)
		D	H	T	L		
RH2H	6.35	19.3	20	9.5	145	6	80



※ This product is registered design.

#### Repair kit

#### Models RK-RH2H

Suitable model : RH2H, RH2HS  
Parts table No.1-7 is one set.

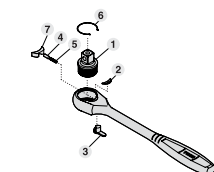

RH2H Parts Diagram

#### RH2H Parts table

NO.	Descriptions	Qty.
1	Gear Assembly	1
2	Dust cap	1
3	Small Handle	1
4	Bush	1
5	Spring	1
6	Retaining Ring	1
7	Wedge	1

#### CAUTION

- Repair may be difficult for the general public.
- We do not sell parts by part.

72-tooth gear with feed angle of 5°. Efficient for small place as compact head adopted Holding socket tightly. Exchange socket with one-push button.



Good Design award

RH2H

Socket holding mechanism



※ When attaching or removing, please make sure to pressing a push button.

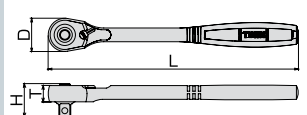

## SHORT SWIVEL RATCHET HANDLE (SOCKET HOLD TYPE)

Models	Square Drive (mm)	Dimensions(mm)				Qty./ Carton (Generally)	Weight (g)
		D	H	T	L		
RH2VHS	6.35	29.6	28.5	21	150	6	142



A heading can control the angle freely 180 deg. (With lock mechanism)

※ This product is registered design.

#### Repair kit

#### Models RK-RH2VH

Suitable model : RH2VHS Parts table No.1-2 is one set.

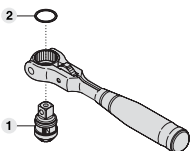

RH2VHS Parts Diagram

#### RK-RH2VH Parts table

NO.	Descriptions	Qty.
1	Driving part	1
2	Retaining Ring	1

#### CAUTION

- Repair may be difficult for the general public.
- We do not sell parts by part.

Two segment cams are used for 72 teeth, equivalent to 144 teeth (feed angle 2.5°). The head part can adjust the angle freely by the lock mechanism. The grip is made of aluminum and light, short type with good workability. Socket is easy to attach and detach, with a socket hold mechanism, the socket will harder to come off during operation. Exchanged socket with one push button.



Round

RH2VHS

Socket holding mechanism



※ When attaching or removing, please make sure to pressing a push button.

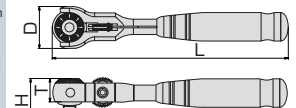
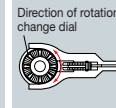

#### For hand tool CAUTION

- Use ratchet handles slowly and softly.
- Switch over the direction completely.